

# Centrifugal Fan MR480M

## Single Inlet Centrifugal Fan

### General Characteristics:

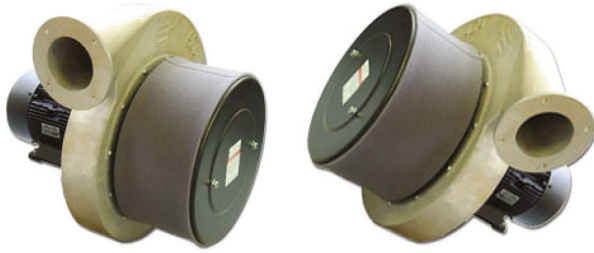

Please note - image above may not be representative of the unit supplied]

<b>Motor type:</b>	Squirrel cage induction motor IP55 as std, IP65 available
<b>Nominal supply:</b>	690/400V 3Ph 50Hz 720/460V 3Ph 60Hz
<b>Options:</b>	Inlet & discharge guards, Inlet filters, Spigots
<b>Materials:</b>	Fan case: Cast aluminium LM6 Impellers: Steel
<b>Finishes:</b>	Unpainted/Stove enamel (black) as std
<b>Mounting options:</b>	Motor feet or Pedestal
<b>Noise levels:</b>	84.2dB(A) Free Air, 1M
<b>Weight:</b>	148Kgs / 326Lbs (fitted with I32 frame motor, 11kW)
<b>Motor variations:</b>	ATEX, CE, CSA, UL available

### Outline dimensions:

[note: motor shown is for 50Hz performance.  
Motor dimensions for 60Hz operation may vary]

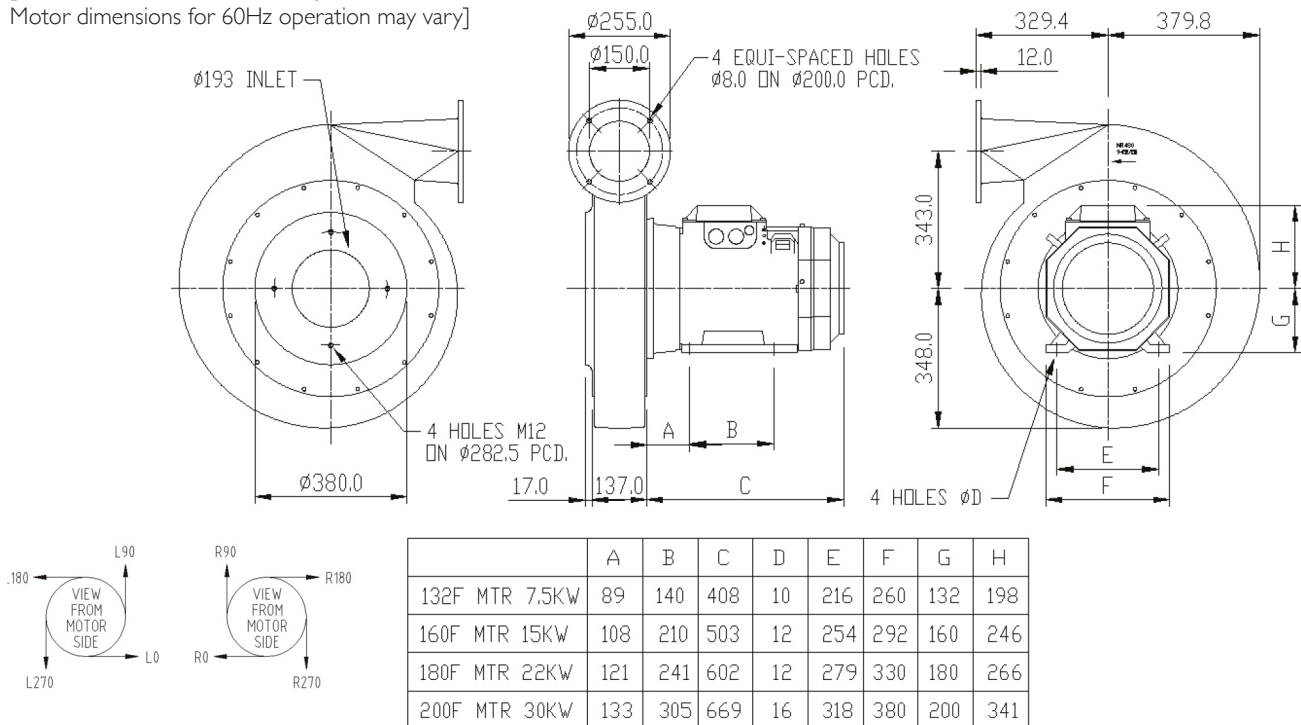

Please note (1) - all drawings measurements are in millimeters (mm)  
Please note (2) - above technical specifications are subject to change

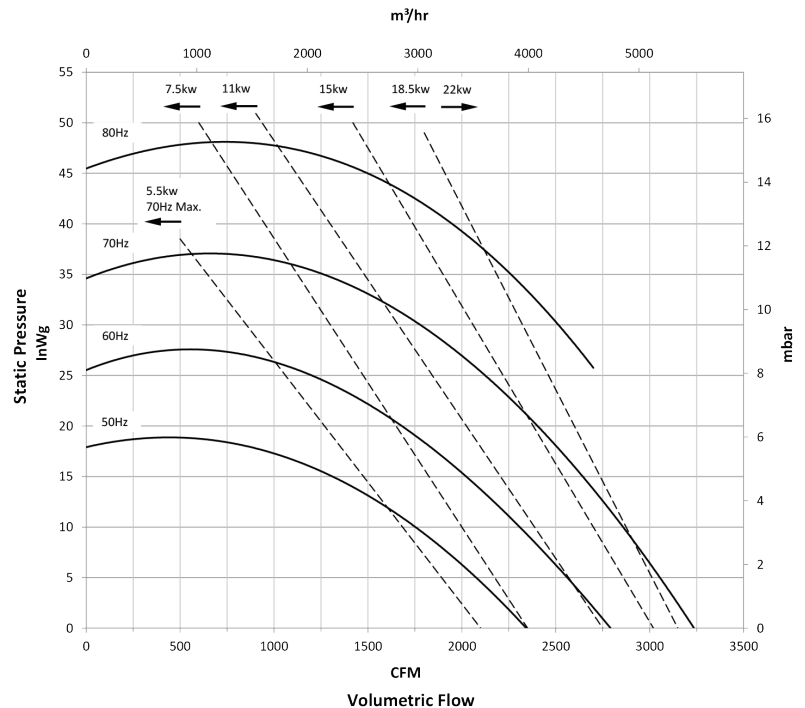

### Air Control Industries Ltd

Weycroft Avenue, Millwey Rise Industrial Estate,  
Axminster, Devon, EX13 5HU, United Kingdom  
Tel: +44(0)1297 529242 Fax: +44(0)1297 529241  
Email: [sales@aircontrolindustries.com](mailto:sales@aircontrolindustries.com)

[www.aircontrolindustries.com](http://www.aircontrolindustries.com)