

Centrifugal Fan MR315L

2 Pole Single Inlet Centrifugal Fan

General Characteristics:



- Motor type:** Squirrel cage induction motor IP55 as std, IP65 available

- Nominal supply:** 380/420VY / 220/240VD 3Ph 50Hz
440/480VY / 250/280VD 3Ph 60Hz

- Options:** Inlet & discharge guards, Inlet filters, Spigots

- Materials:** Fancase: Cast aluminium LM6
Impellers: Galvanised sheet steel

- Finishes:** Unpainted / Stove enamel (black) as std

- Mounting options:** Motor feet or Pedestal

- Noise levels:** 96dB(A) Free Air, 1M

- Weight:** 71Kgs / 157Lbs

- Motor variations:** ATEX, CE, CSA, UL available

Outline dimensions:

[note: motor shown is for 50Hz performance.
Motor dimensions for 60Hz operation may vary]

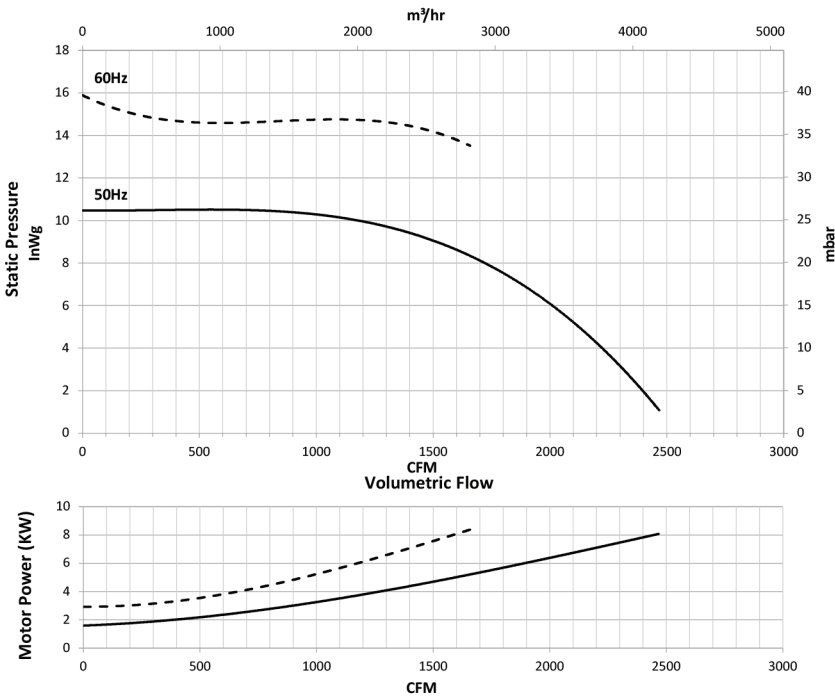
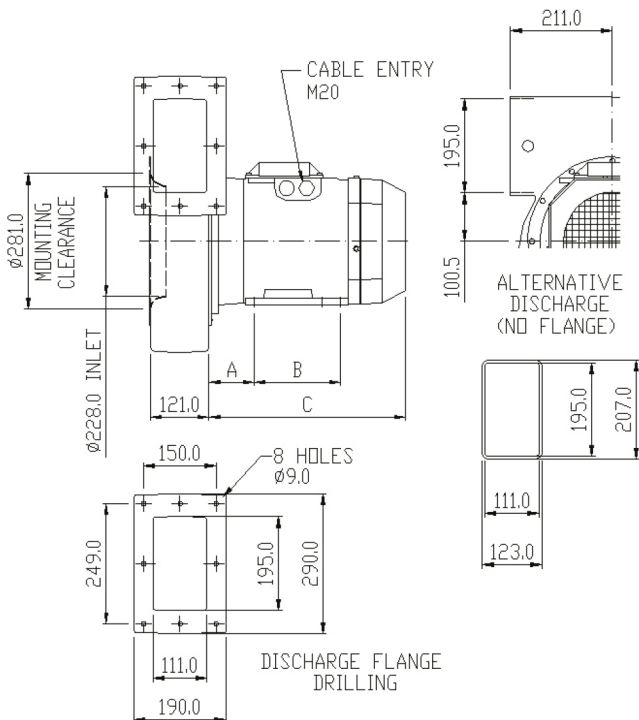

Please note:

- 1 - all drawings measurements are in millimeters (mm)
- 2 - below technical specifications are subject to change
- 3 - Images used may not be representative of the fan supplied

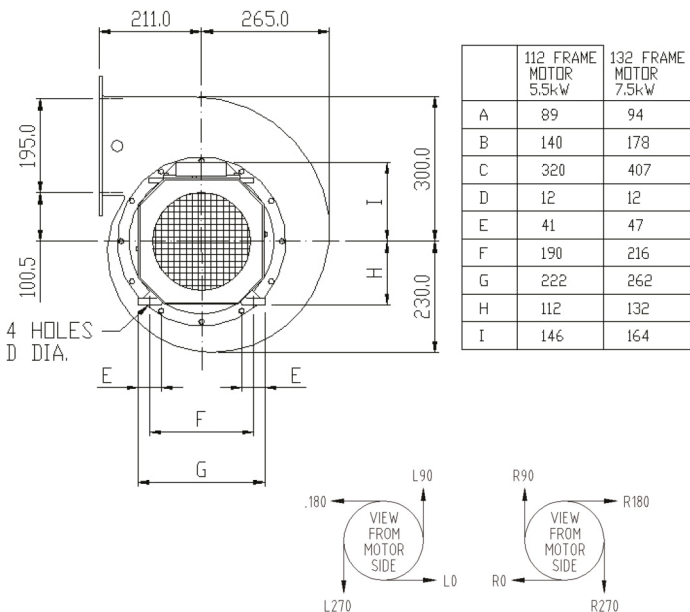

Air Control Industries Ltd
 Weycroft Avenue, Millwey Rise Industrial Estate,
 Axminster, Devon, EX13 5HU, United Kingdom
 Tel: +44(0)1297 529242 Fax: +44(0)1297 529241
 Email: sales@aircontrolindustries.com

www.aircontrolindustries.com