

Centrifugal Fan VBM5

Single Inlet Centrifugal Fan

General Characteristics:



Please note - image above may not be representative of the unit supplied]

Motor type: Squirrel cage induction motor IP44 as std, IP55 available

Nominal supply: 230V 1Ph 50/60Hz
110/115V 1Ph 50/60Hz
Dual Voltage 3Ph 50/60Hz

Options: Inlet & discharge guards, Inlet filters, Spigots, Heat spinners

Materials: Fancase: Cast aluminium LM6
Impellers: Aluminium 1200 H14

Finishes: Unpainted/Stove enamel (black) as std

Mounting options: Motor feet or Pedestals

Noise levels: 70dB(A) Free Air, 1M

Weight: 5Kgs / 11Lbs

Motor variations: ATEX, CE, CSA, UL available

Outline dimensions:

[note: motor shown is for 50Hz performance.
Motor dimensions for 60Hz operation may vary]

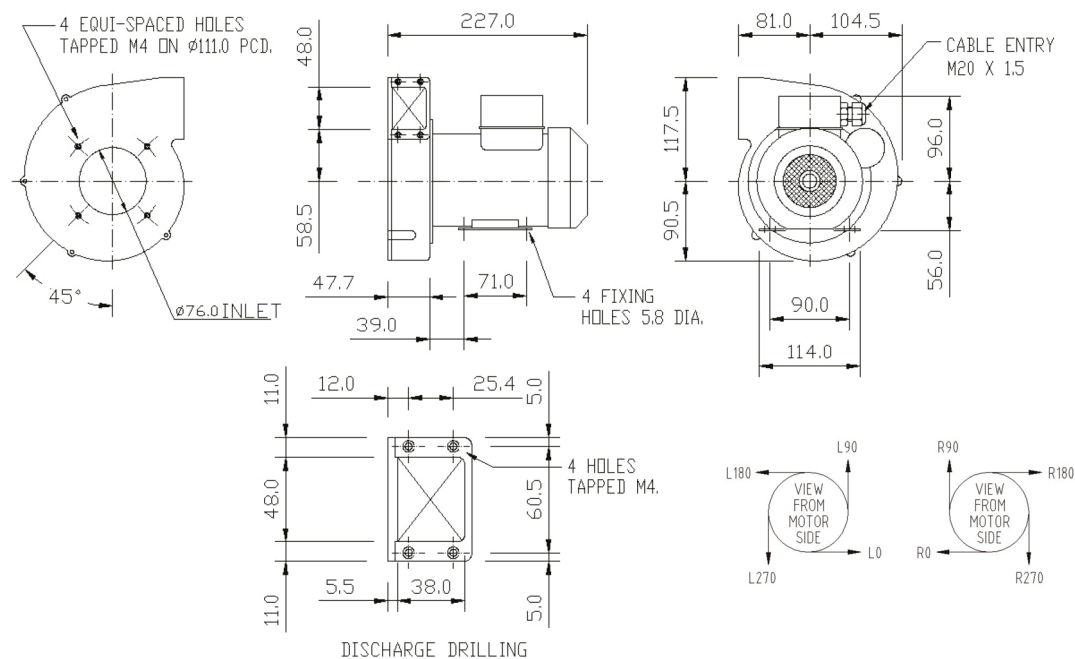

Please note (1) - all drawings measurements are in millimeters (mm)
Please note (2) - above technical specifications are subject to change

